



525 ISLAND SPIRIT



The Island Spirit brand was introduced into the United States and the Caribbean charter market in 1998. It instantly became a much sought after catamaran, mainly because of the revolutionary design which offered both optimal space and superior sailing performance. Over 70 Island Spirits have been built, 35 of which were sold in the United States between 1998 and 2006. To this day Island Spirit multihulls are still extremely popular in the second hand market as well.

The Island Spirit 37 was the first model launched in 1998 followed by the Island Spirit 400 in 2001. In 2003 Amanzi Marine redesigned and launched the Island Spirit 401. The Island Spirits have been awarded Top Ten Sail Magazine awards in 2001, 2003 and 2005. In 2003 the boat was also a nominee for boat of the year.

In 2014 Island Spirit moved production to Thailand to provide its customers with the most competitive pricing while maintaining its highest commitment to

quality. The initial model launched in 2014 was the IS380 which is now in use across Asia in bareboat charter companies, by day trip operators and a number of personal cruisers. In 2017 Island Spirit launched the first IS 410 with models specifically developed for the bareboat charter operator, the day trip operator and for personal cruising. The IS410 is CE Certified Category A.

In 2022 Island Spirit introduced the IS 525 to the sailing catamaran family.

## ABOUT US







Group Island Spirit is pleased to announce the new Island Spirit 525. The IS 525 has been developed through multiple partnerships to match customer requirements to the ideal vessel design based on years of experience in the charter industry. Island Spirit is a unique builder as we also operate a large charter fleet.

We took our initial design concepts for the IS 525 and shared that with several charter partners to converge on the final design.



#### Electric Drive (EV)

The development of the IS 525 a key aspect from the beginning was to be able to design the boat with the electric drive option.

The first and foremost key is that it is affordable, second is that it is safe and reliable and finally is that it is functionally practical.

To meet these goals Group Island Spirit partnered with major system developers in the EV industry for the development of the drive system. The drive system has been developed to meet the ISO 16315 small craft requirements and is based on a concept of having multiple charging options and maximum power storage. This allows for optimal flexibility whether cruising or at anchor.

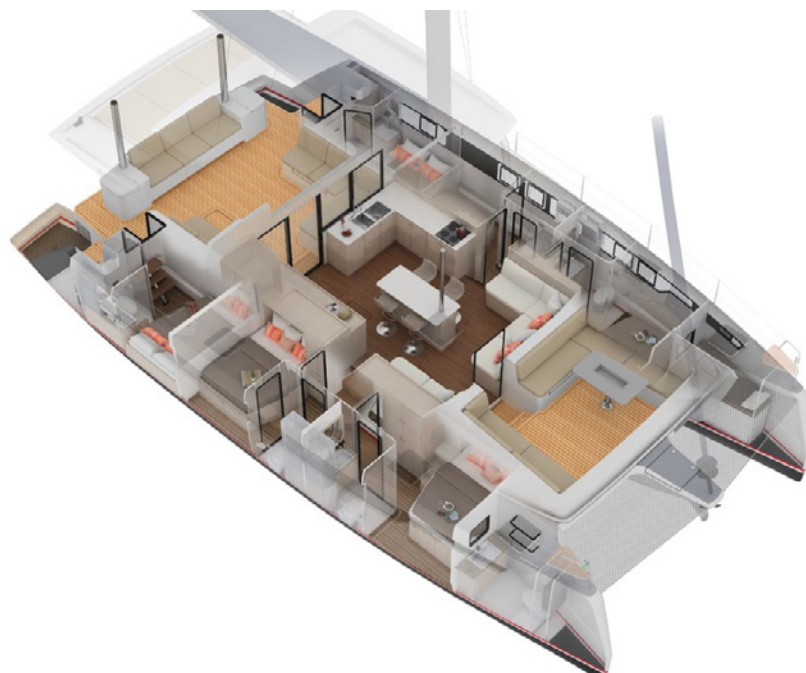

## Key Features

- Spacious flybridge with excellent sailing visibility
- Large aft seating area for group gatherings and meals
- Walk through salon for easy access to forward seating and foredeck
- Latest and best sailing and navigation technology
- State of the art entertainment facilities
- EV power standard, optional 57hp and 80hp diesel engines
- Inverted & wave piercing bows
- Large galley and storage area
- All ensuite cabin configurations
- Crew accommodations
- Available in 3, 4, 5 or 6 cabin configuration with 2 optional forepeak cabins
- Storage, storage, storage

## Innovation

The hulls and decks of all Island Spirit multihulls are vacuum-infused under a negative pressure of -1 atmosphere. Island Spirit uses hi-density PVC closed-cell foam core for low weight, high strength and maximum durability. The Vacuum infusion process creates a hull & deck that is at least 35% lighter weight, and far stiffer than any comparable boat manufactured by traditional single-skin hand-lay or vacuum bagging techniques.

This affords the IS 525 with a significant sail area to displacement ratio making her an excellent sailing machine. The massive reduction in resin used in the process, together with the compaction of the fiberglass layers & foam core, results in the optimum resin to glass ratios - and additionally allows us to remain very competitive whilst using the highest quality resins, cores & laminates. However, perhaps the most important factor resulting from this techniques is that it virtually eliminates any "voids" or "cavities" in the structural laminate - preventing any chance of "osmosis" in the hull structure. No wood is used in the structural build of the IS 525. All bulkheads are vacuum infused foam bonded into the structure. This results in quiet sailing (No creaking) and a solid sea worthy structure.







## INTERIOR

IS 525

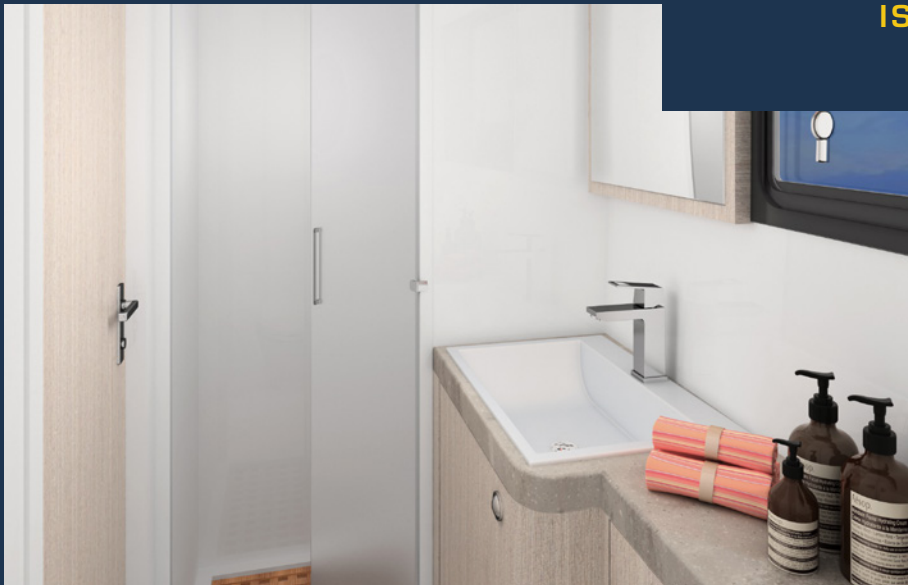



## Comfort

The Island Spirit design philosophy has been carried over to each boat design, making it unique and alluring.

Features include a large aft seating area for group entertaining and meals as well as a large galley area that is perfect for group meal prep and entertaining.

The large dual access flybridge provides maximum space with ample seating and incorporates an integrated hardtop bimini that doubles as a platform for solar implementation. The walk-through salon to forward seating area creates easy access to comfort with a built in sunshade.

The cabins are comfortably spacious and can easily be closed off for privacy with the privacy sliding doors.

The heads are beautifully appointed and ventilated for optimum comfort and the chef's galley is unequalled on any catamaran in this size range. The Island Spirit 525 is spacious enough to comfortably accommodate two families, a long-term cruising couple or a whole group of charter guests on vacation.

With modern innovative construction technology the Island Spirit 525 is carefully designed so that every space is optimally used to enhance comfort.

## Main Deck Saloon Layout

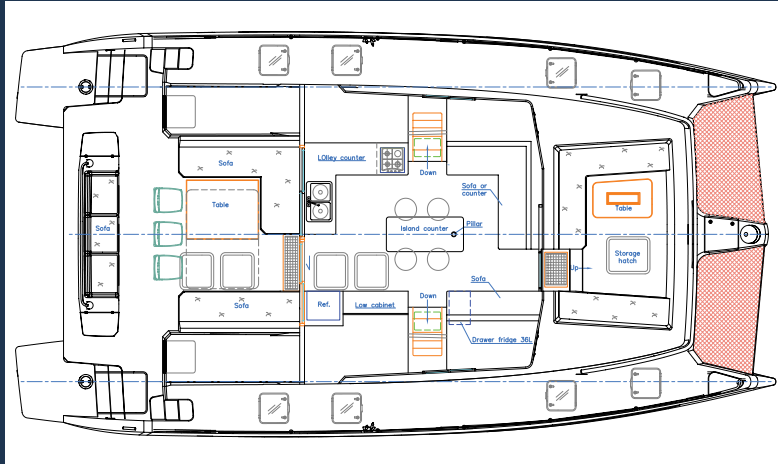

Specifications	Metric	Imperial
Length Overall	15.77 m	51.7 ft
Beam	8.19 m	26.9 ft
Draft	1.54 m	5.1 ft
Displacement	16.5 Tons	36,376 lbs
Fuel Capacity	1000 Liters	264 Gallons
Water Capacity	1000 Liters	264 Gallons
Mainsail Area	122 m <sup>2</sup>	1,313 ft <sup>2</sup>
Jib Area	55 m <sup>2</sup>	592 ft <sup>2</sup>
Sail Area	177 m <sup>2</sup>	1,905 ft <sup>2</sup>

## Different Model Layouts

### 3 Cabin with Crew Quarters

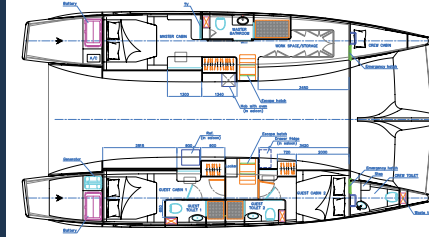

### 3 Cabin with Storage

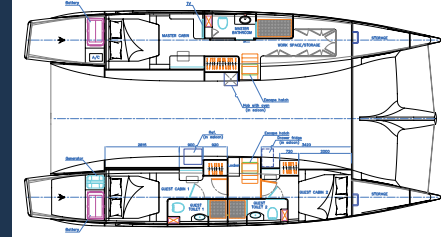

### 4 Cabin with Crew Quarters

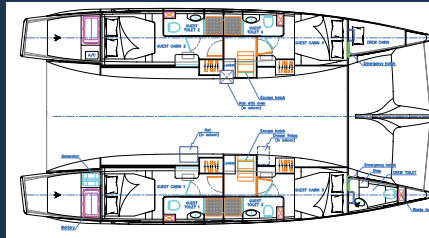

### 4 Cabin with Storage

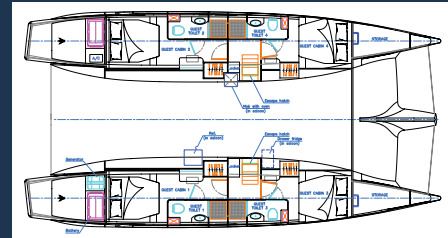

### 5 Cabin with Crew Quarters

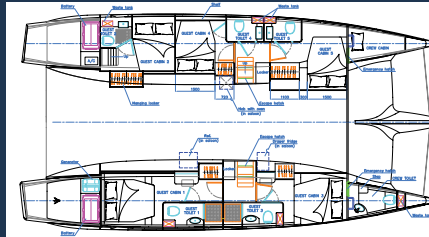

### 5 Cabin with Storage

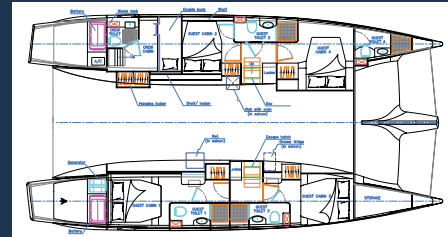

### 6 Cabin with Crew Quarters

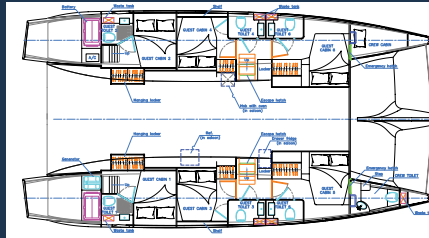

### 6 Cabin with Storage

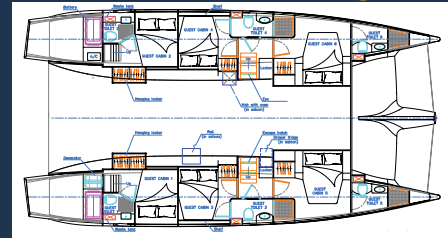





### **Thailand**

Group Island Spirit Manufacturing  
533/16 Moo 10  
Hua Yai, Banglamung  
Chonburi, 20250  
Email: [sales@groupislandspirit.com](mailto:sales@groupislandspirit.com)

### **USA**

Group Island Spirit Inc.  
7524 Jack Newell Blvd S.  
Fort Worth, Texas 76119 USA  
Email: [info@groupislandspirit.com](mailto:info@groupislandspirit.com)

**[groupislandspirit.com](http://groupislandspirit.com)**